

SPECIFICATIONS

FREQUENCY BAND Tx: 17.30 - 18.40 GHz
Rx: 10.70 - 12.75 GHz

INSERTION LOSS Tx: 0.25 dB MAX
Rx: 0.25 dB MAX

VSWR Tx: 1.25:1 MAX
Rx: 1.25:1 MAX

ISOLATION Tx/Rx: 85 dB MIN
Rx/Tx: 85 dB MIN

CROSS-POL : 35 dB MIN

PRESSURIZATION : SEALED TO 1.0 PSIG

FINISH

FLANGE FACES : ZINC-NICKEL PLATED
(PER AMS 2417G, TYPE II, CLASS 2) D
EXTERIOR : WHITE PAINT, COLOR N_o 17875
PER FED-STD-595

REVISIONS

ZONE	REV.	DESCRIPTION	DATE	APPROVED
D	D	SEE EC N _o 12923	12/19/2013	
E	E	SEE EC N _o 12957	2/4/2014	

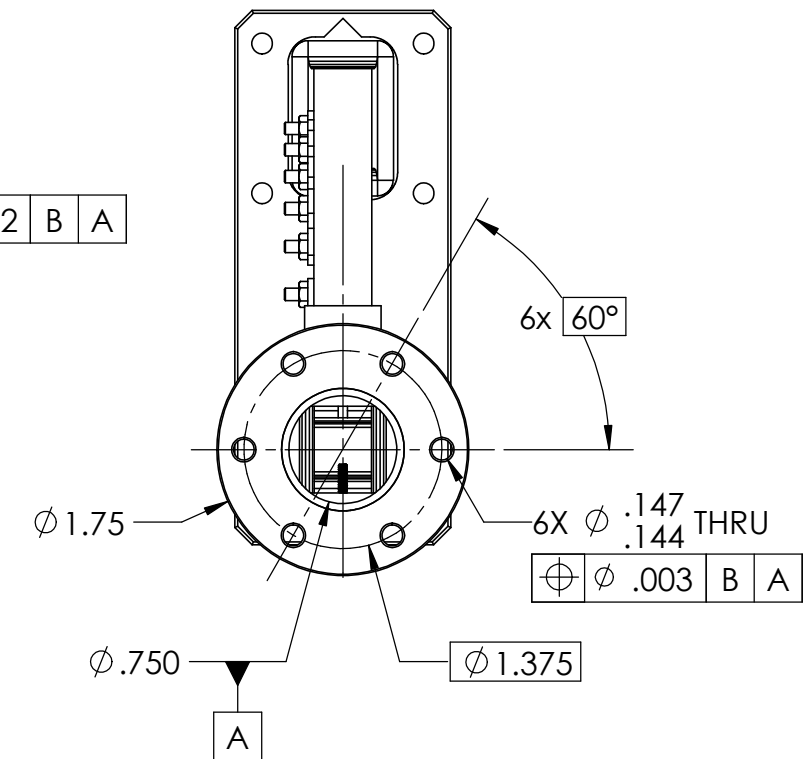
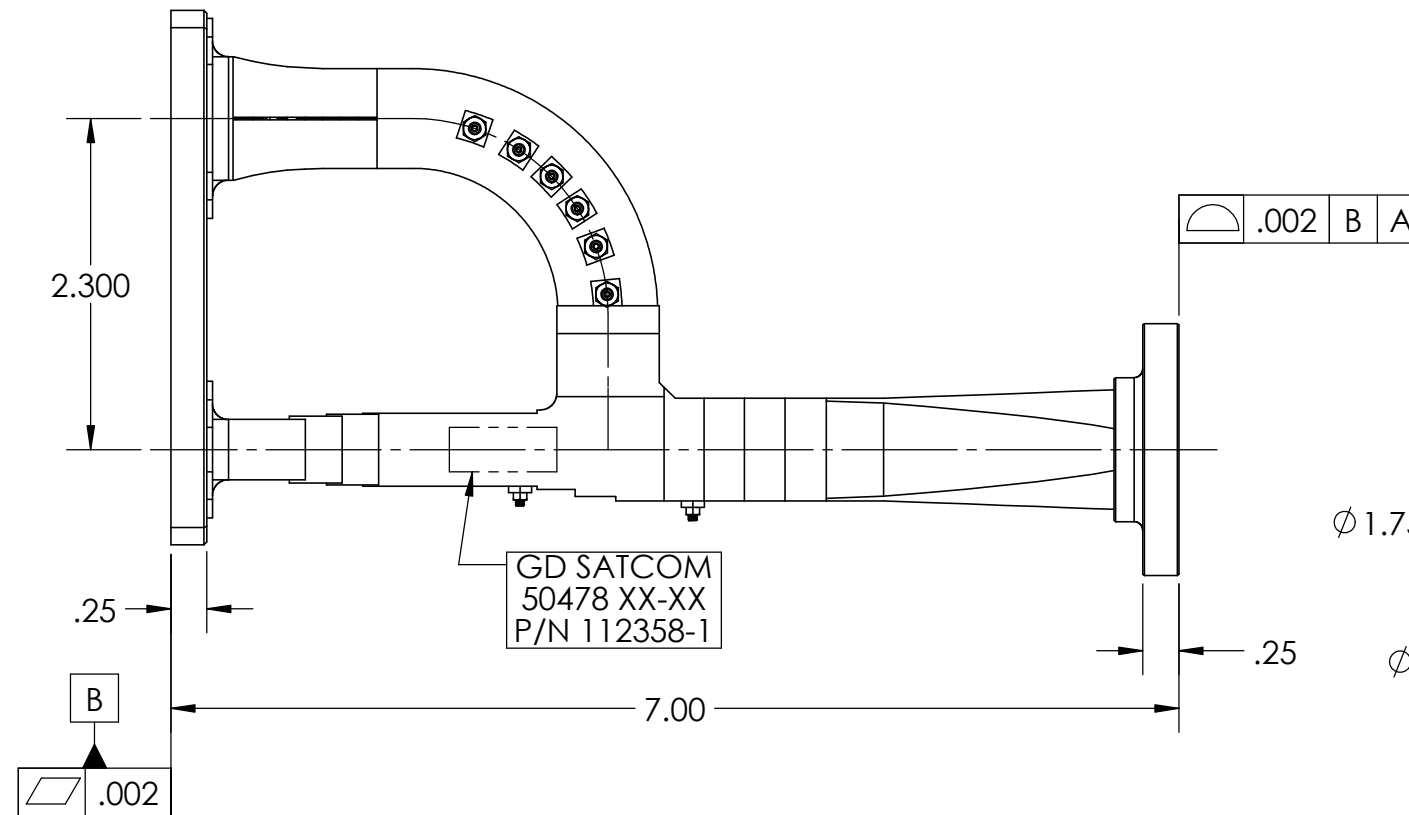
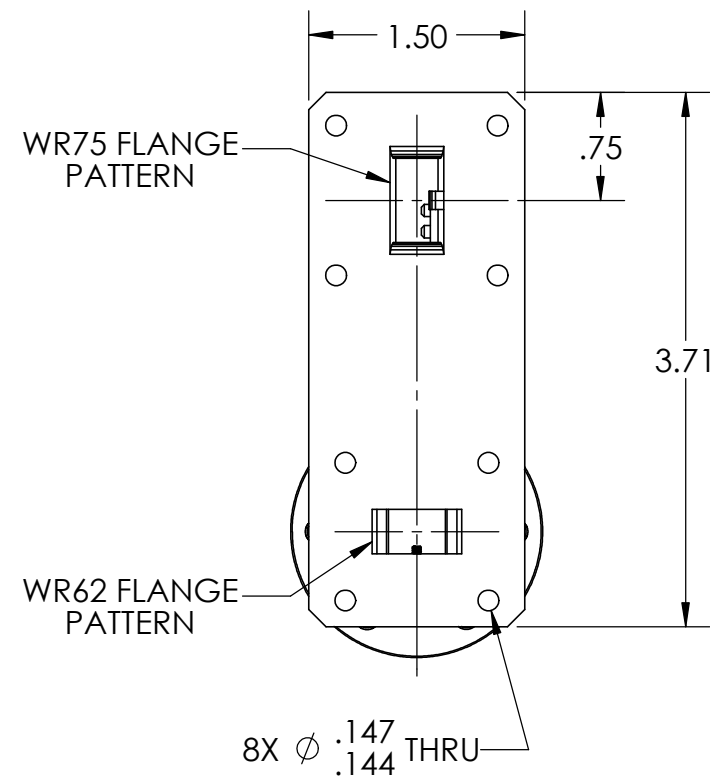

NOTES: UNLESS OTHERWISE SPECIFIED.

DO NOT SCALE DRAWINGS		APPROVALS		DATE	GENERAL DYNAMICS PROPRIETARY GENERAL DYNAMICS SATCOM Technologies 3111 Fujita Street, Torrance CA 90505, (310) 539-6704				
UNLESS OTHERWISE SPECIFIED, INTERPRET DIMENSIONING & TOLERANCING PER ANSI/ASME Y14.5M-2009. DIMENSIONS ARE IN INCHES. DIMENSIONS SHOWN IN () ARE FOR REFERENCE ONLY. TOLERANCES: TWO PLACE DECIMAL ± .01 THREE PLACE DECIMAL ± .002 FOUR PLACE DECIMAL ± .0010 ANGLES ± 0°30'		DRAWN: L. Tovalin	02-10-00						
		CHECKED: H. Spieleder	02-10-00						
		RF DESIGN:							
		MFG:							
		QA:			TITLE: DIPLEXER, Ku-BAND 2-PORT				
		ENG MGR:							
		PROJECT:			SIZE	CAGE CODE	DWG N _o	REV	
THIRD ANGLE PROJECTION		EAR CONTROLLED		MATERIAL		B	50478	112358-1	E
		Export or re-export subject to 15 CFR 700 - 799		EF COPPER ALLOY		SCALE: 3:4	WEIGHT: 1.017 LB	SHEET 1 of 2	